

Attachment 1

Jetty Road

Transition & Coastal Zone

Gordon and Partridge Street to Moseley Square

Prepared for City of Holdfast Bay

Acknowledgement of Country

We pay our respects to the Traditional Custodians of Country throughout Australia, their Elders and ancestors, recognising their rich heritage and enduring connection to Country and acknowledging the ongoing sovereignty of all Aboriginal and Torres Strait Islander Nations.

We recognise the profound connection to land, waters, sky and community of the First Nations peoples, with continuing cultures that are among the oldest in human history. We recognise that they are skilled land shapers and place makers, with a deep and rich knowledge of this land which they have cared for, protected and balanced for millennia.

Our Country, 2022
88 x 119 cm Acrylic on canvas
Original artwork by
Alfred Carter
Gunaikurnai

Quality Assurance

Jetty Road, Glenelg
Transition and Coastal Zone
Landscape Concept Report

Prepared for
City of Holdfast Bay

Project Number
322-0567-00-L-07-RP01

Revisions

No.	Date	Description	Prepared By	Reviewed By	Project Principal
01	19 November 2024	Draft	MN/SG	GS	HE
02	20 November 2024	Draft	MN/SG	HE	HE
03	10 December 2024	Draft	SG/ZC	HE	HE
04	13 December 2024	Draft	SG	HE	HE
05	14 January 2025	Draft	SG/IDZ/ILC	HE	HE
06	24 January 2025	Draft - Community Consultation Pack	SG	HE	HE
07	29 January 2025	Community Consultation Pack	SG	HE	HE

1 Overall Landscape Concept Plan - Transition and Coastal Zone

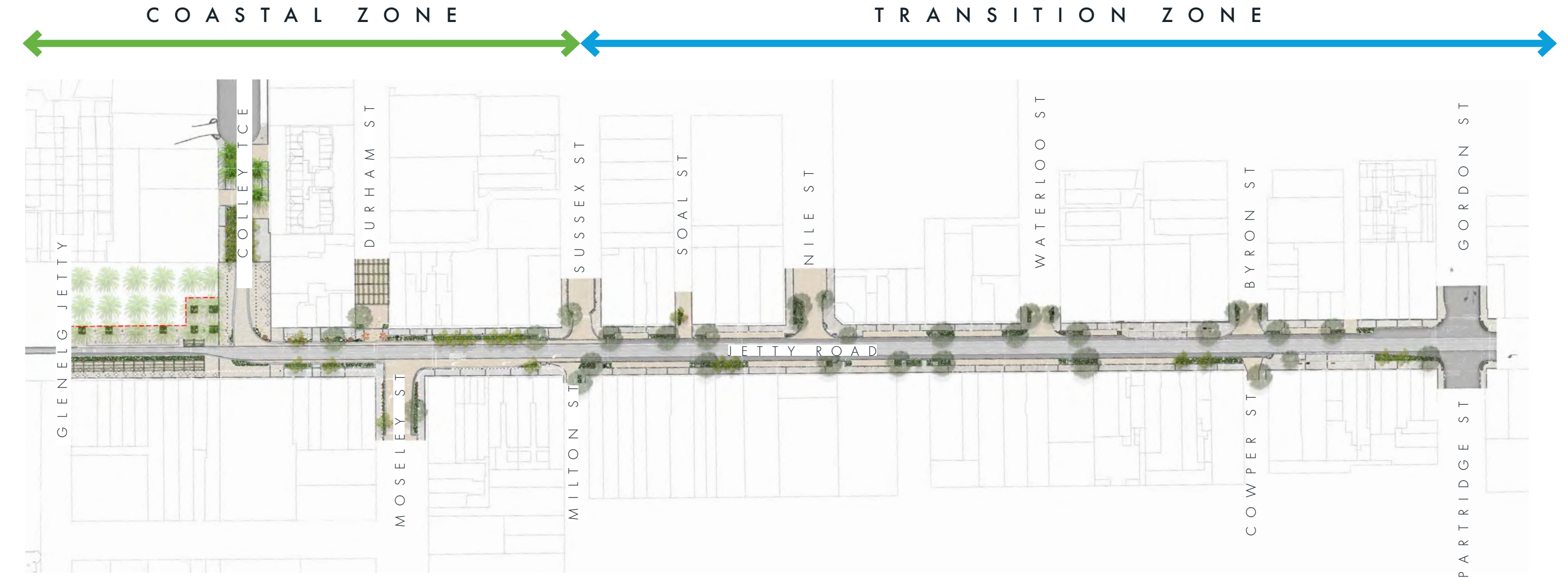

*Overall plan showing Coastal Zone Option 1

Legend

Existing Street Tree	Proposed Bollards	Proposed Uplighting to Trees
Proposed Street Tree	Proposed Bike Racks	Existing Light Pole
Asphalt	Proposed Rubbish Bins	Existing Tram Pole
Proposed Pavement	Proposed Single Seat	Existing CCTV Pole
Proposed Banding	Proposed Double Seat	Potential Public Art Sculpture
Proposed Feature Paving	Proposed Arbour Structure	
Proposed Crossing Paving	Proposed Shading Structure	

2 Plan: Coast Zone - Concept Blue

A redesigned Colley Terrace that focuses on pedestrian safety and experience. Palm trees frame both sides of the Colley Terrace entry, and a widened verges create opportunity for street planting embedding principles of water sensitive urban design. Garden beds with integrated outdoor dining and ornamental pebble seats provide respite at key points while creating a buffer between road and pathways. Illuminating the plaza after dark is feature strip lighting, creating a space which can transform from a space of day to night activation.

Private Vehicles:

- Closure of Colley Terrace (Hope Street) to Jetty Road (Moseley Street) to all private vehicles

Buses:

- 1 way westbound bus movements from Moseley Street
- Changed Bus Routes and New Bus Stops
- New Moseley Street bus stop layovers
- New Gordon Street bus stops
- Increased bus stops along Jetty Road

Changes to road:

- Moseley Street intersection signalised for safer pedestrian crossing
- Narrowed carriageway on Colley Terrace maximises space for pedestrians, outdoor dining, activation opportunities and trees/greening.
- Closure of Durham Street from Jetty Road. Durham Street converted to two way traffic movements.
- 30 km/h zone for whole street

Legend

	Existing Street Tree		Proposed Bollards		Proposed Uplighting to Trees		Traffic Signal Poles
	Proposed Street Tree		Proposed Bike Racks		Existing Light Pole		Signal lanterns Mounted to Existing Tram Pole
	Asphalt		Proposed Rubbish Bins		Existing Tram Pole		
	Proposed Pavement		Proposed Single Seat		Existing CCTV Pole		
	Proposed Banding		Proposed Double Seat		Potential Public Art Sculpture		
	Proposed Feature Paving		Proposed Arbour Structure		In-ground Strip Lighting		
	Proposed Crossing Paving		Proposed Shading Structure		Seating Pebbles		



CONTINUES ON NEXT PAGE

3 Plan: Coast Zone - Concept Green

A redesigned Colley Terrace that enhances pedestrian safety and experience. Palm trees frame both sides of the Colley Terrace entry, and a widened verges creates opportunity for street planting embedding principles of water sensitive urban design. Garden beds with integrated outdoor dining and ornamental pebble seats provide respite at key points while creating a buffer between road and pathways. Illuminating the plaza after dark is feature strip lighting, creating a space which can transform from a space of day to night activation.

- Private Vehicles:**
- Closure of Colley Terrace (Hope Street) to Jetty Road (Moseley Street) to all private vehicles
 - Improved paving treatment which ties into overall Jetty Road design
- Buses:**
- Open to 2 way bus movements
 - Increased pedestrian amenity and safety due to removal of private vehicles
- Changes to road:**
- Moseley Street intersection signalised for safer pedestrian crossing
 - Slightly narrowed carriageway allows for minor increase in pedestrian space, outdoor dining, activation opportunities and trees/greening.
 - Closure of Durham Street from Jetty Road. Durham Street converted to two way traffic movements.
 - 30 km/h zone for whole street
 - 10km/h zone (Between Moseley street and Hope St)
- Pedestrians:**
- Flush kerbs from Colley Terrace (from Hope Street) to Jetty Road (Moseley Street) gives pedestrians priority to create a piazza feel within Moseley Square area
 - Palm trees framing either side of Colley Terrace to provide attractive entry statement
 - Verge planting integrating WSUD (Water Sensitive Urban Design) principles
 - Increased trees and associated green canopy coverage

Greening Opportunities including WSUD

Legend

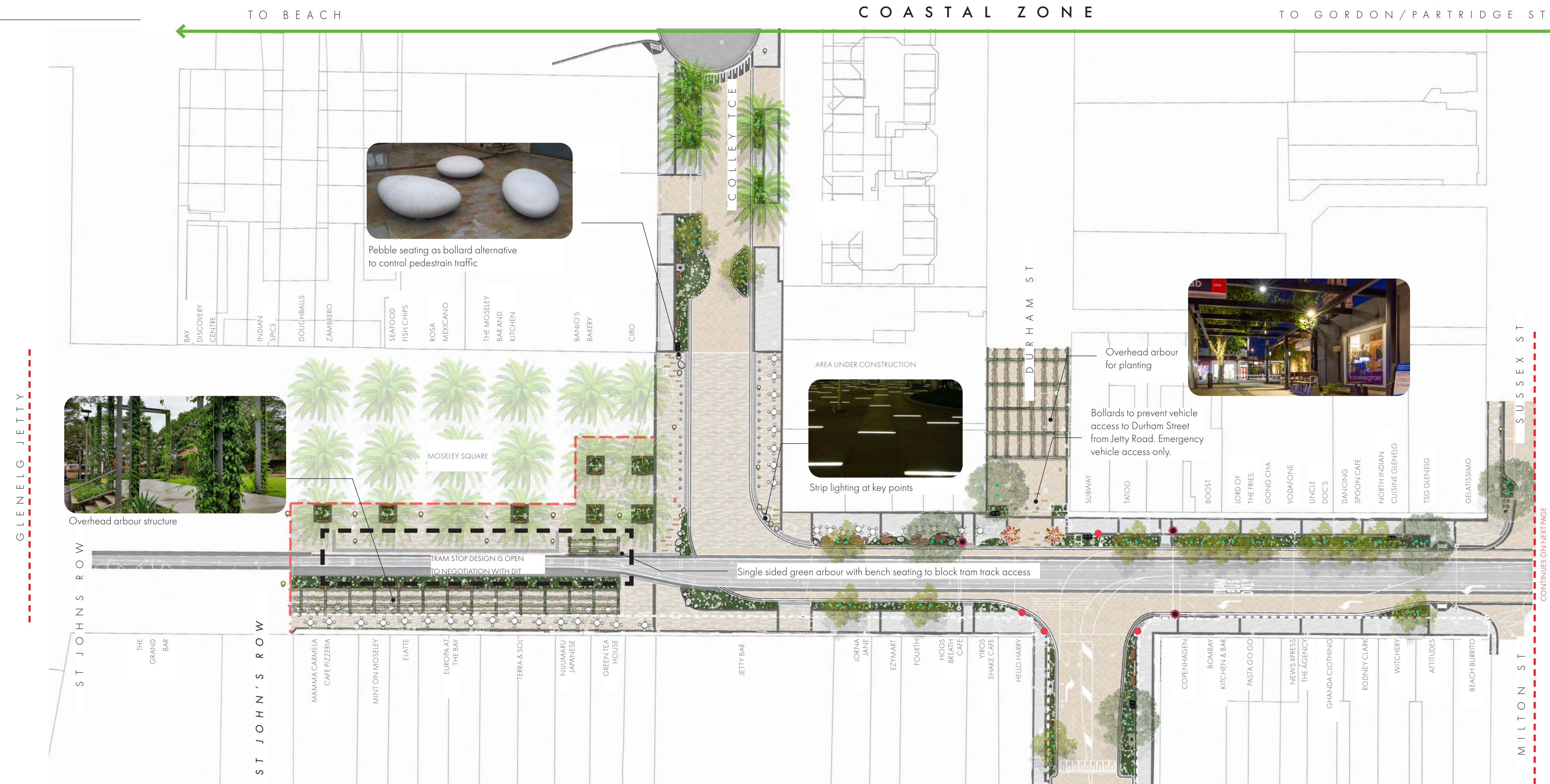

CONTINUES ON NEXT PAGE

4 Plan: Coast Zone - Concept Yellow

A redesigned Colley Terrace that improves the pedestrian experience and retains vehicle movements. Palm trees line Colley Terrace's western side, and a wide western verge creates opportunity for street planting embedding principles of water sensitive urban design. Garden beds with integrated outdoor dining and ornamental feature pebble seats provide respite at key points while creating a buffer between road and pathways. Illuminating the plaza after dark is feature strip lighting, creating a space which can transform from a space of day to night activation.

- Private Vehicles:**
- All private vehicle movement retained
 - Carparking on North-East Colley Terrace
- Buses:**
- All bus movements retained
- Changes to road:**
- Moseley Street intersection signalised for safer pedestrian crossing
 - Existing road width retained
 - Closure of Durham Street from Jetty Road to create a small plaza. Durham Street converted to two way traffic movements.
 - Option to incorporate a left hand turn into Durham from Jetty Road and remove the plaza.
- Pedestrians:**
- Flush 'shared zone' in Colley Terrace (from Hope Street) to Jetty Road (Moseley Street) gives pedestrians priority, and creates a piazza feel within Moseley Square area
 - Improved paving treatment which ties into overall Jetty Road design
- Greening Opportunities including WSUD**
- Palm trees on West side of Colley Terrace to provide attractive entry statement
 - Verge planting integrating WSUD (Water Sensitive Urban Design) principles
 - Increased trees and associated green canopy coverage

Legend

	Existing Street Tree		Proposed Bollards		Proposed Uplighting to Trees		Traffic Signal Poles
	Proposed Street Tree		Proposed Bike Racks		Existing Light Pole		Signal lanterns Mounted to Existing Tram Pole
	Asphalt		Proposed Rubbish Bins		Existing Tram Pole		
	Proposed Pavement		Proposed Single Seat		Existing CCTV Pole		
	Proposed Banding		Proposed Double Seat		Potential Public Art Sculpture		
	Proposed Feature Paving		Proposed Arbour Structure		In-ground Strip Lighting		
	Proposed Crossing Paving		Proposed Shading Structure		Seating Pebbles		

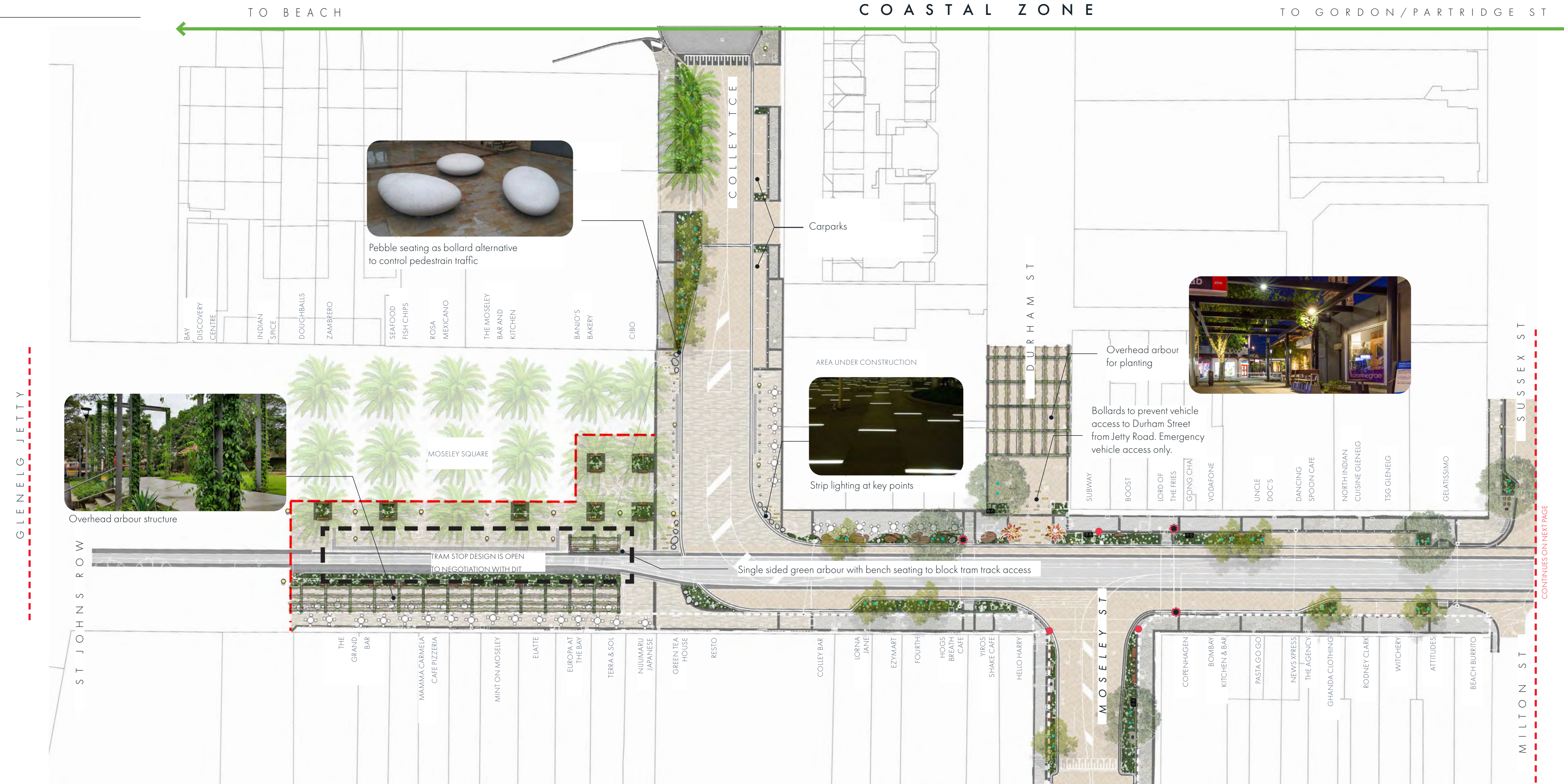

5 Plan - Transition Zone

Flexible Zones utilised for parking and activation.

Private Vehicles:

- All private vehicle movement retained

Buses:

- All bus movements retained

Pedestrians:

- 'Flexible Zones' for use as either parking or opportunities for businesses to expand into on a pop-up basis
- Upgraded seating and bike racks at revised locations
- Improved paving treatment which ties into overall Jetty Road design

Greening Opportunities including WSUD

- Additional trees and retainment of all healthy existing trees for increased green canopy cover and associated street shading
- Increased ground level planting

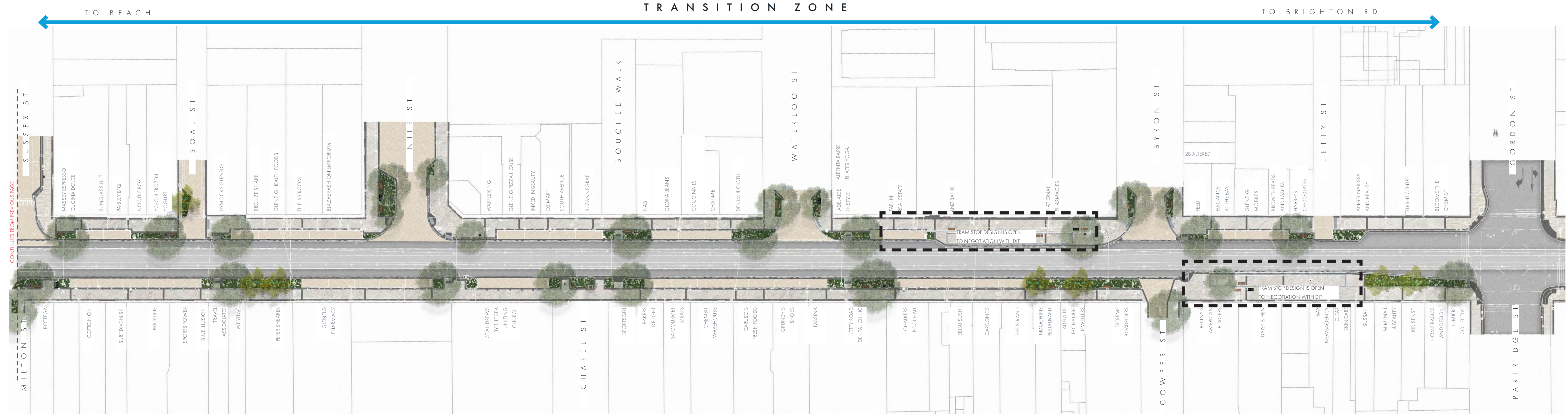

Legend

Existing Street Tree	Proposed Pavement	Proposed Crossing Paving	Proposed Rubbish Bins	Proposed Arbour Structure	Existing Light Pole	Potential Public Art Sculpture
Proposed Street Tree	Proposed Banding	Proposed Bollards	Proposed Single Seat	Proposed Shading Structure	Existing Tram Pole	
Asphalt	Proposed Feature Paving	Proposed Bike Racks	Proposed Double Seat	Proposed Uplighting to Trees	Existing CCTV Pole	



6 Plant Palette

6.1 Plant Selection

TREES

Jetty Road Planting

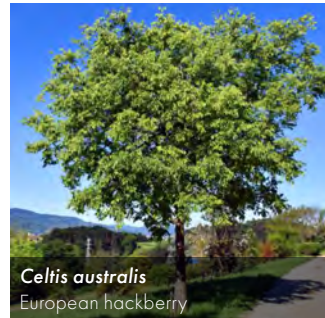

Celtis australis
European hackberry

Colley Terrace Planting

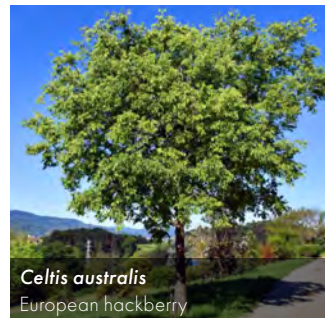

Celtis australis
European hackberry



Phoenix canariensis
Canary Island date palm

Side Street Planting



Gleditsia triacanthos
Honey Locust



Brachychiton populneus x acerifolius 'Jerilderie Red'
Jerilderie Red



Cupaniopsis anacardioides
Tuckeroo

SHRUBS + GROUNDCOVERS

Garden Bed Planting - 200mm pots

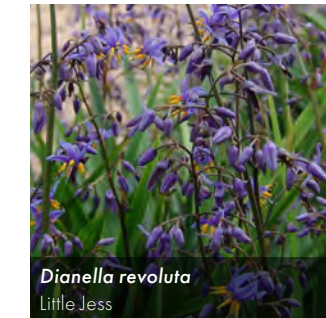

Dianella revoluta
Little Jess



Dianella revoluta
Black Anther Flax Lily



Hardenbergia comptoniana
Native Wisteria

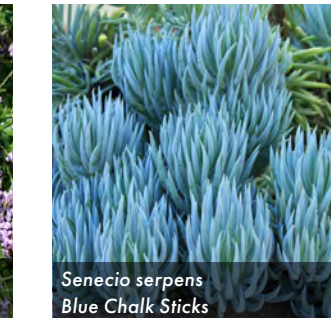

Senecio serpens
Blue Chalk Sticks



Zamia furfuracea
Cardboard Palm

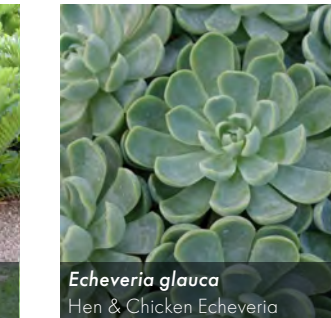

Echeveria glauca
Hen & Chicken Echeveria

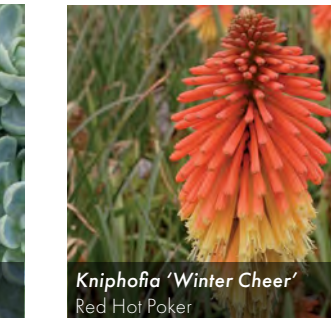

Kniphofia 'Winter Cheer'
Red Hot Poker

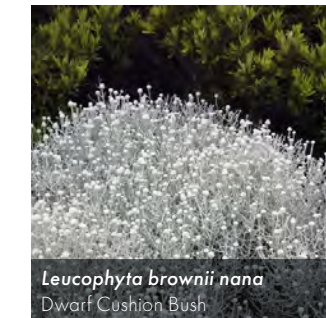

Leucophyta brownii nana
Dwarf Cushion Bush



Scaevola 'Zig Zag'
Fairy Fan Flower



Westringia fruticosa 'Milky Way'
Coastal Rosemary



Cassia Blue Dianella caerulea 'DBB03' PBR
Cassia Blue Dianella



Tasred Dianella tasmanica 'TR20' PBR
Tasred Dianella

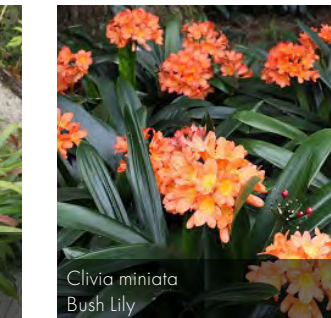

Clivia miniata
Bush Lily



Cycas revoluta
Sagó Palm



Thaumatococcus xanadu
Philodendron Xanadu



Alcantarea imperialis 'Silver Plum'
Giant Bromeliad



Viburnum odoratissimum
Sweet Viburnum



Buxus microphylla
Japanese Box

WSUD Planting - 200mm pots



Lomandra longifolia 'Tanika'
Tanika Mat Rush



Poa labillardieri 'Eskdale'
Tussock Grass

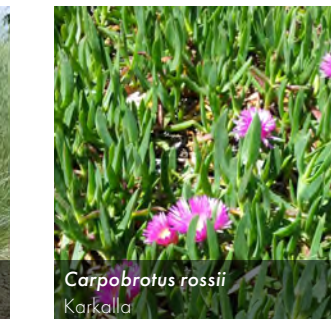

Carpobrotus fossii
Karikala

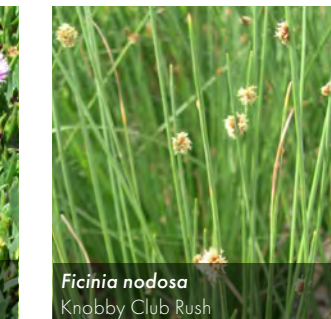

Ficinia nodosa
Knobby Club Rush



Themeda triandra
Kangaroo Grass

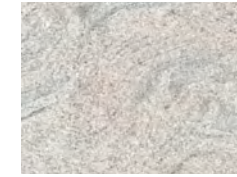
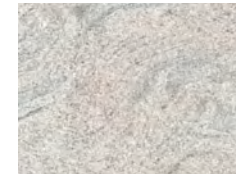
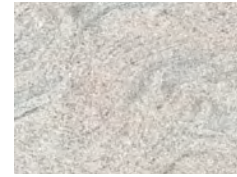

Crossings: Juperana *Herringbone Pattern*

Footpath Paving: Juperana *Stretcherbond Pattern*

Moseley Piazza: Juperana *Pattern TBC*



Cobbleset Banding:
Austral Black Stone

Footpaths: 100 mm x 100 mm x 40 mm [charcoal oxide mortar]

Crossovers: 100 mm x 100 mm x 60 mm

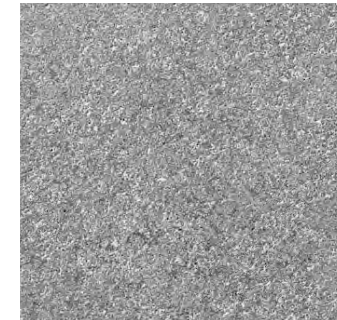

On-street Carpark Pavement
Asphalt



Semi-mountable Kerb
Black oxide to match existing Chapel St Plaza works



Upright Kerb
Black oxide to match existing Chapel St Plaza works



Footpath, Feature + Crossover Paving:
Juperana Granite

Footpaths: 400 mm x 200 mm x 40 mm in Stretcherbond

Feature Paving: Juperana Granite - various sizes, random pattern to match City Zone

Crossovers: Juperana Granite - 400 mm x 200 mm x 60 mm in Herringbone



Corten Edging
to garden beds where required



Bin Enclosure
to match Chapel St Plaza



Bike Racks
Street Furniture Australia to match Chapel St Plaza



Bollards
Street Furniture Australia to match Chapel St Plaza



Strip Lights (Trafficable)
to be developed during detailed design



Seat on Plinth
Seats along Colley Terrace to match Chapel St Plaza

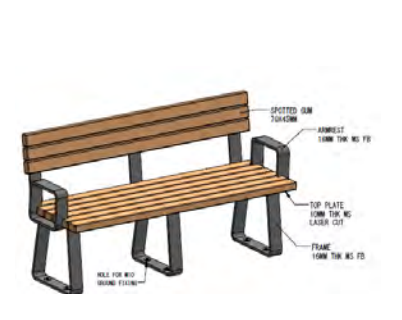

Seat
Seats along Jetty Road to match Chapel St Plaza with extended legs in place of plinth

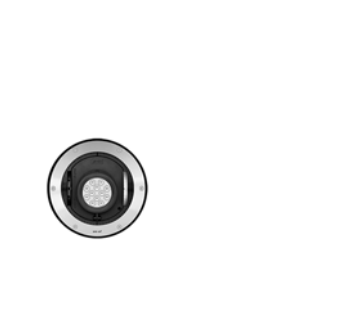

Tree Uplights
to be developed during detailed design

Contact Tract

Adelaide
Kaurna Country
265 Pirie St, Adelaide SA, Australia 5000
(08) 8223 1324
adelaide@tract.net.au

Attachment 2

Jetty Road

Transition & Coastal Zone

Gordon and Partridge Street to Moseley Square

Prepared for City of Holdfast Bay

Acknowledgement of Country

We pay our respects to the Traditional Custodians of Country throughout Australia, their Elders and ancestors, recognising their rich heritage and enduring connection to Country and acknowledging the ongoing sovereignty of all Aboriginal and Torres Strait Islander Nations.

We recognise the profound connection to land, waters, sky and community of the First Nations peoples, with continuing cultures that are among the oldest in human history. We recognise that they are skilled land shapers and place makers, with a deep and rich knowledge of this land which they have cared for, protected and balanced for millennia.

Our Country, 2022
88 x 119 cm Acrylic on canvas
Original artwork by
Alfred Carter
Gunaikurnai

Quality Assurance

Jetty Road, Glenelg
Transition and Coastal Zone
Landscape Concept Report

Prepared for
City of Holdfast Bay

Project Number
322-0567-00-L-07-RP01

Revisions

No.	Date	Description	Prepared By	Reviewed By	Project Principal
01	19 November 2024	Draft	MN/SG	GS	HE
02	20 November 2024	Draft	MN/SG	HE	HE
03	10 December 2024	Draft	SG/ZC	HE	HE
04	13 December 2024	Draft	SG	HE	HE
05	14 January 2025	Draft	SG/IDZ/ILC	HE	HE
06	24 January 2025	Draft - Community Consultation Pack	SG	HE	HE
07	29 January 2025	Community Consultation Pack	SG	HE	HE

1 Overall Landscape Concept Plan - Transition and Coastal Zone

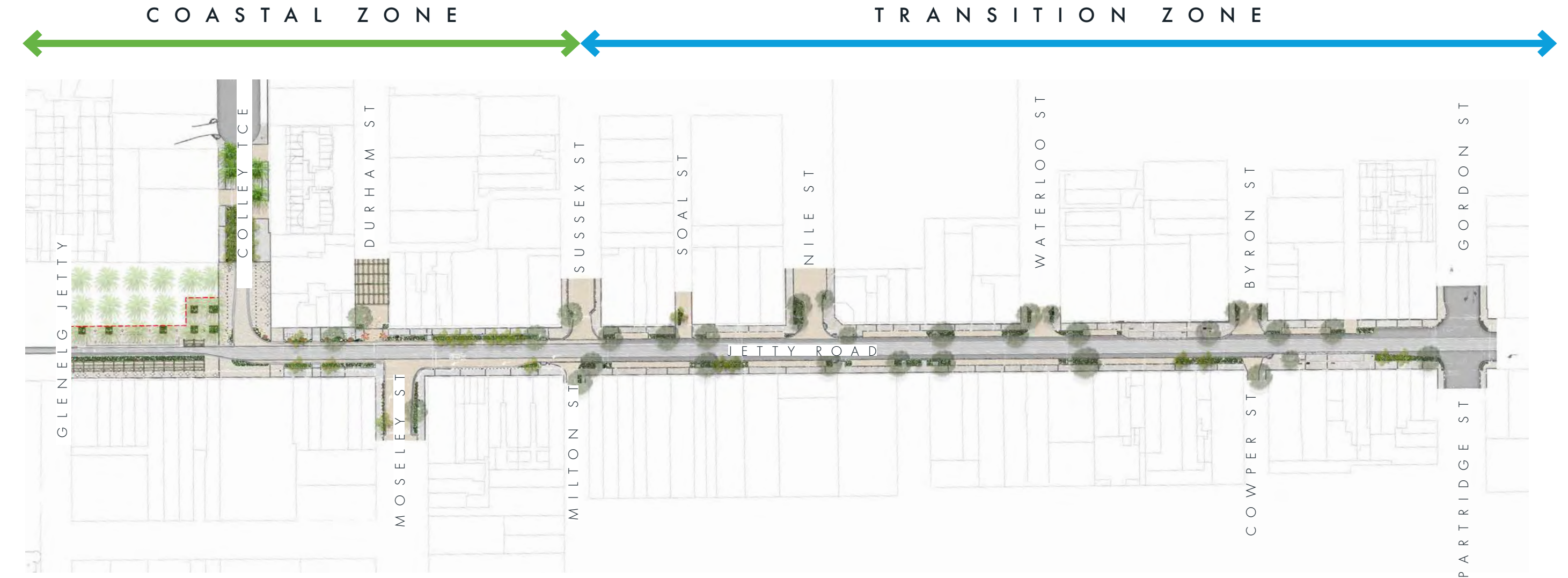

*Overall plan showing Coastal Zone Option 1

Legend

Existing Street Tree	Proposed Bollards	Proposed Uplighting to Trees
Proposed Street Tree	Proposed Bike Racks	Existing Light Pole
Asphalt	Proposed Rubbish Bins	Existing Tram Pole
Proposed Pavement	Proposed Single Seat	Existing CCTV Pole
Proposed Banding	Proposed Double Seat	Potential Public Art Sculpture
Proposed Feature Paving	Proposed Arbour Structure	
Proposed Crossing Paving	Proposed Shading Structure	

2 Plan: Coast Zone - Concept Blue

A redesigned Colley Terrace that focuses on pedestrian safety and experience. Palm trees frame both sides of the Colley Terrace entry, and a widened verges create opportunity for street planting embedding principles of water sensitive urban design. Garden beds with integrated outdoor dining and ornamental pebble seats provide respite at key points while creating a buffer between road and pathways. Illuminating the plaza after dark is feature strip lighting, creating a space which can transform from a space of day to night activation.

Private Vehicles:

- Closure of Colley Terrace (Hope Street) to Jetty Road (Moseley Street) to all private vehicles

Buses:

- 1 way westbound bus movements from Moseley Street
- Changed Bus Routes and New Bus Stops
- New Moseley Street bus stop layovers
- New Gordon Street bus stops
- Increased bus stops along Jetty Road

Changes to road:

- Moseley Street intersection signalised for safer pedestrian crossing
- Narrowed carriageway on Colley Terrace maximises space for pedestrians, outdoor dining, activation opportunities and trees/greening.
- Closure of Durham Street from Jetty Road. Durham Street converted to two way traffic movements.
- 30 km/h zone for whole street

Legend

	Existing Street Tree		Proposed Bollards		Proposed Uplighting to Trees		Traffic Signal Poles
	Proposed Street Tree		Proposed Bike Racks		Existing Light Pole		Signal lanterns Mounted to Existing Tram Pole
	Asphalt		Proposed Rubbish Bins		Existing Tram Pole		
	Proposed Pavement		Proposed Single Seat		Existing CCTV Pole		
	Proposed Banding		Proposed Double Seat		Potential Public Art Sculpture		
	Proposed Feature Paving		Proposed Arbour Structure		In-ground Strip Lighting		
	Proposed Crossing Paving		Proposed Shading Structure		Seating Pebbles		



CONTINUES ON NEXT PAGE

3 Plan: Coast Zone - Concept Green

A redesigned Colley Terrace that enhances pedestrian safety and experience. Palm trees frame both sides of the Colley Terrace entry, and a widened verges creates opportunity for street planting embedding principles of water sensitive urban design. Garden beds with integrated outdoor dining and ornamental pebble seats provide respite at key points while creating a buffer between road and pathways. Illuminating the plaza after dark is feature strip lighting, creating a space which can transform from a space of day to night activation.

- Private Vehicles:**
- Closure of Colley Terrace (Hope Street) to Jetty Road (Moseley Street) to all private vehicles
 - Improved paving treatment which ties into overall Jetty Road design
- Buses:**
- Open to 2 way bus movements
 - Increased pedestrian amenity and safety due to removal of private vehicles
- Changes to road:**
- Moseley Street intersection signalised for safer pedestrian crossing
 - Slightly narrowed carriageway allows for minor increase in pedestrian space, outdoor dining, activation opportunities and trees/greening.
 - Closure of Durham Street from Jetty Road. Durham Street converted to two way traffic movements.
 - 30 km/h zone for whole street
 - 10km/h zone (Between Moseley street and Hope St)
- Greening Opportunities including WSUD**
- Palm trees framing either side of Colley Terrace to provide attractive entry statement
 - Verge planting integrating WSUD (Water Sensitive Urban Design) principles
 - Increased trees and associated green canopy coverage
- Pedestrians:**
- Flush kerbs from Colley Terrace (from Hope Street) to Jetty Road (Moseley Street) gives pedestrians priority to create a piazza feel within Moseley Square area

Legend

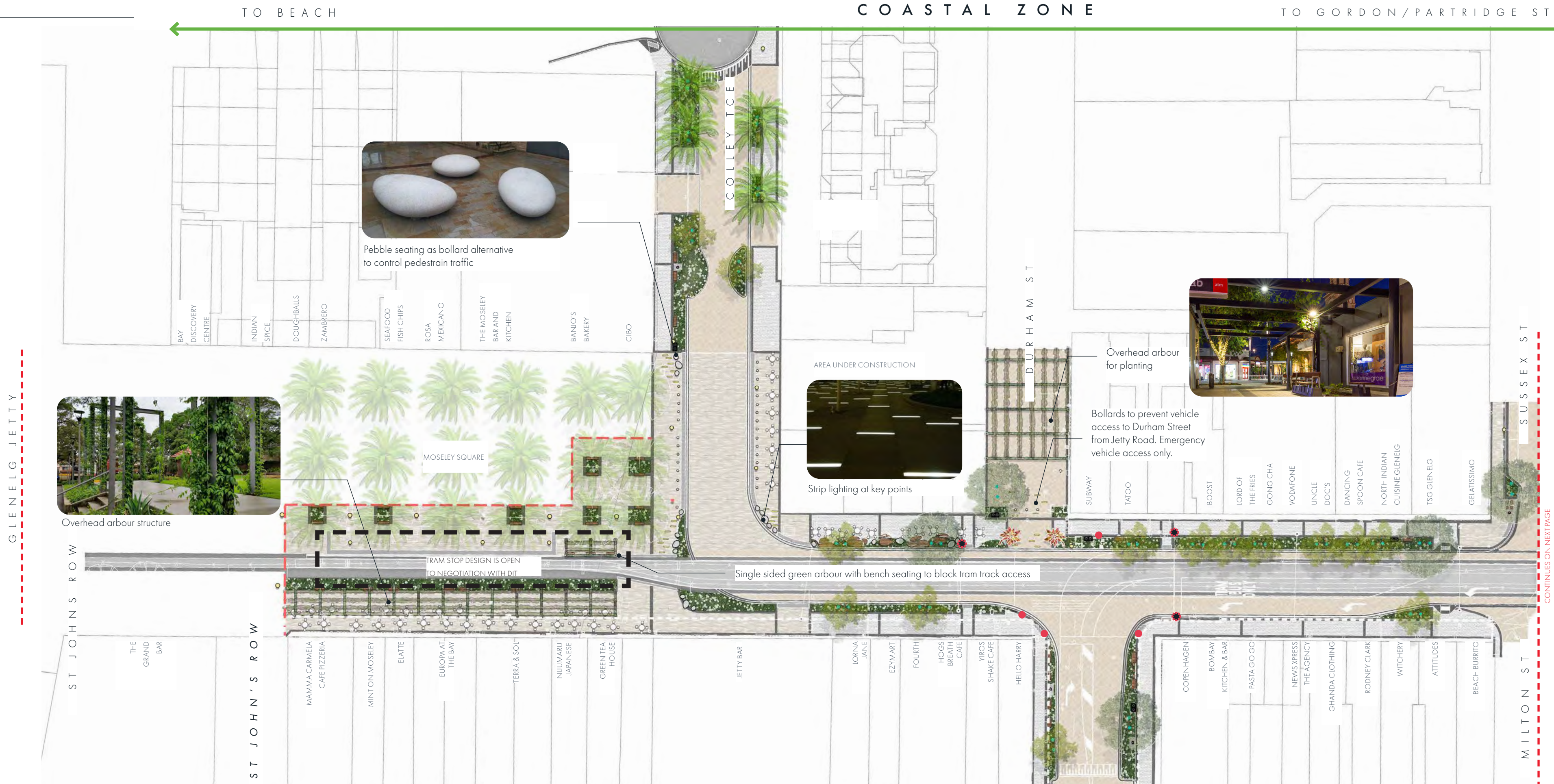

4 Plan: Coast Zone - Concept Yellow

A redesigned Colley Terrace that improves the pedestrian experience and retains vehicle movements. Palm trees line Colley Terrace's western side, and a wide western verge creates opportunity for street planting embedding principles of water sensitive urban design. Garden beds with integrated outdoor dining and ornamental feature pebble seats provide respite at key points while creating a buffer between road and pathways. Illuminating the plaza after dark is feature strip lighting, creating a space which can transform from a space of day to night activation.

- Private Vehicles:**
- All private vehicle movement retained
 - Carparking on North-East Colley Terrace
- Buses:**
- All bus movements retained
- Changes to road:**
- Moseley Street intersection signalised for safer pedestrian crossing
 - Existing road width retained
 - Closure of Durham Street from Jetty Road to create a small plaza. Durham Street converted to two way traffic movements.
 - Option to incorporate a left hand turn into Durham from Jetty Road and remove the plaza.
- Pedestrians:**
- Flush 'shared zone' in Colley Terrace (from Hope Street) to Jetty Road (Moseley Street) gives pedestrians priority, and creates a piazza feel within Moseley Square area
 - Improved paving treatment which ties into overall Jetty Road design
- Greening Opportunities including WSUD**
- Palm trees on West side of Colley Terrace to provide attractive entry statement
 - Verge planting integrating WSUD (Water Sensitive Urban Design) principles
 - Increased trees and associated green canopy coverage

Legend

	Existing Street Tree		Proposed Bollards		Proposed Uplighting to Trees		Traffic Signal Poles
	Proposed Street Tree		Proposed Bike Racks		Existing Light Pole		Signal lanterns Mounted to Existing Tram Pole
	Asphalt		Proposed Rubbish Bins		Existing Tram Pole		
	Proposed Pavement		Proposed Single Seat		Existing CCTV Pole		
	Proposed Banding		Proposed Double Seat		Potential Public Art Sculpture		
	Proposed Feature Paving		Proposed Arbour Structure		In-ground Strip Lighting		
	Proposed Crossing Paving		Proposed Shading Structure		Seating Pebbles		

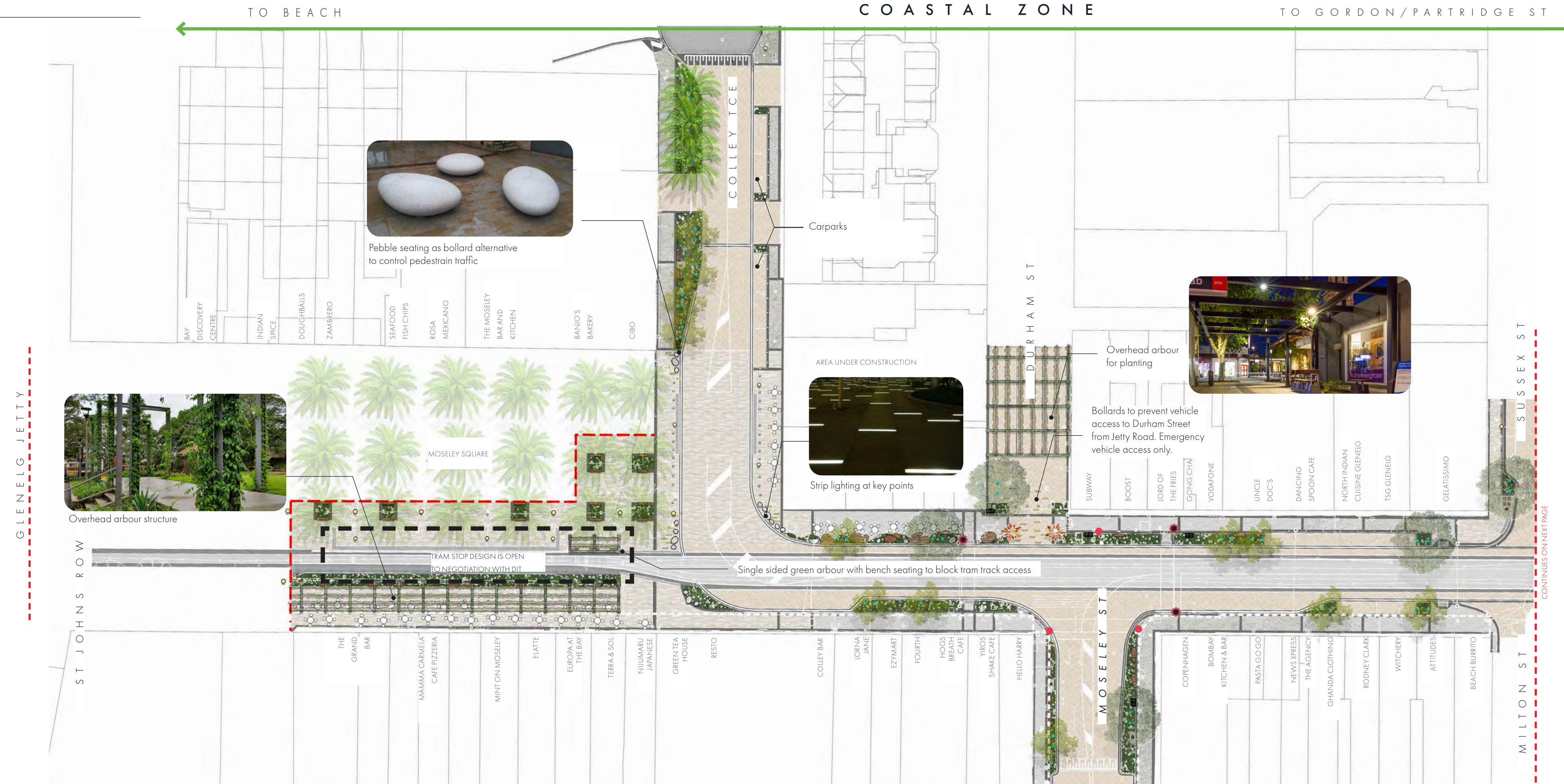

5 Plan - Transition Zone

Flexible Zones utilised for parking and activation.

Private Vehicles:

- All private vehicle movement retained

Buses:

- All bus movements retained

Pedestrians:

- 'Flexible Zones' for use as either parking or opportunities for businesses to expand into on a pop-up basis
- Upgraded seating and bike racks at revised locations
- Improved paving treatment which ties into overall Jetty Road design

Greening Opportunities including WSUD

- Additional trees and retainment of all healthy existing trees for increased green canopy cover and associated street shading
- Increased ground level planting

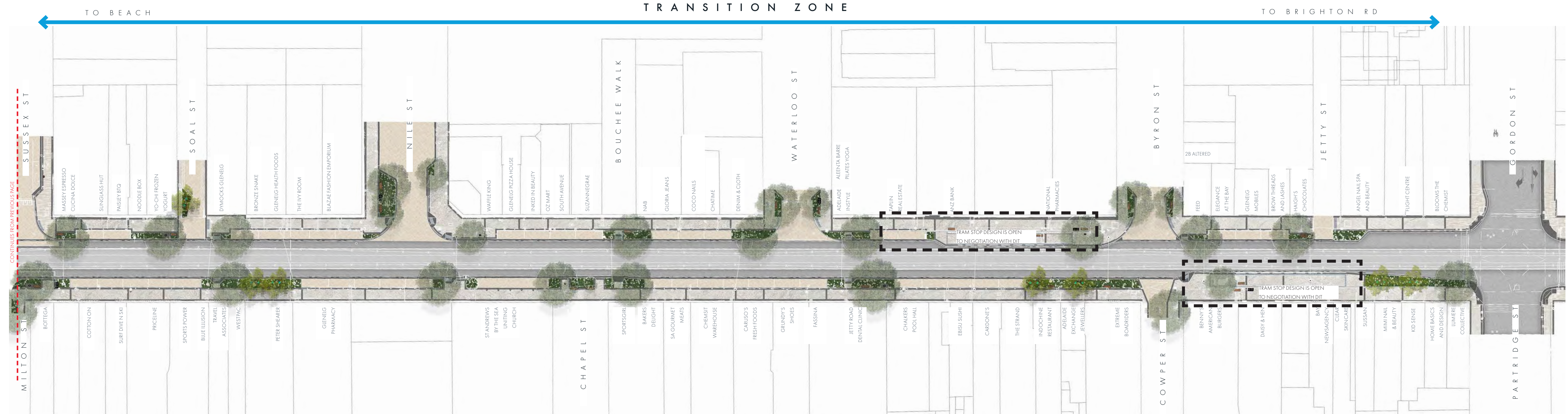

Legend

Existing Street Tree	Proposed Pavement	Proposed Crossing Paving	Proposed Rubbish Bins	Proposed Arbour Structure	Existing Light Pole	Potential Public Art Sculpture
Proposed Street Tree	Proposed Banding	Proposed Bollards	Proposed Single Seat	Proposed Shading Structure	Existing Tram Pole	
Asphalt	Proposed Feature Paving	Proposed Bike Racks	Proposed Double Seat	Proposed Uplighting to Trees	Existing CCTV Pole	



6 Plant Palette

6.1 Plant Selection

TREES

Jetty Road Planting

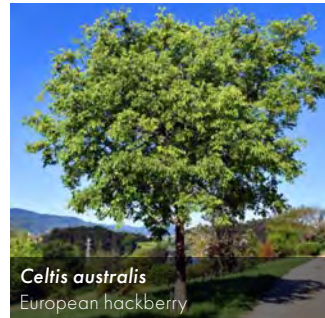

Colley Terrace Planting



Side Street Planting



SHRUBS + GROUNDCOVERS

Garden Bed Planting - 200mm pots

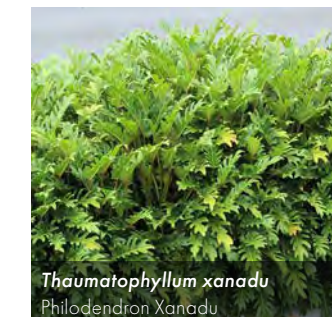
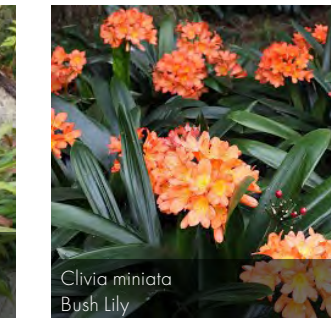
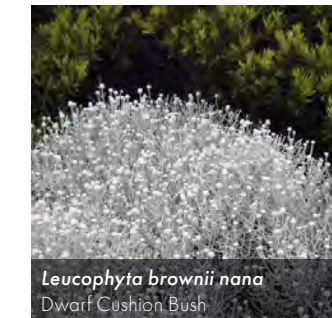
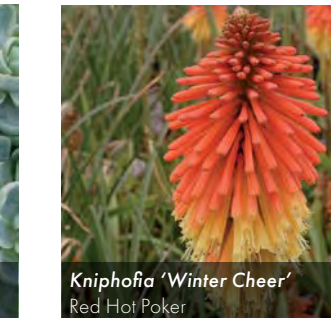
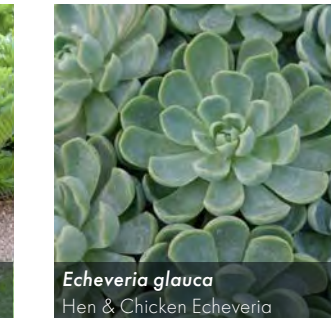
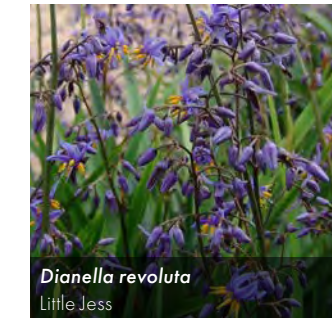

WSUD Planting - 200mm pots

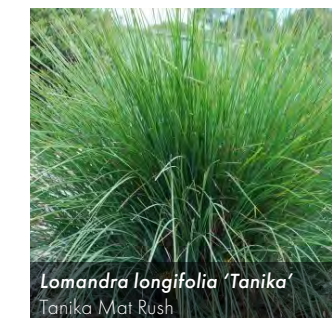

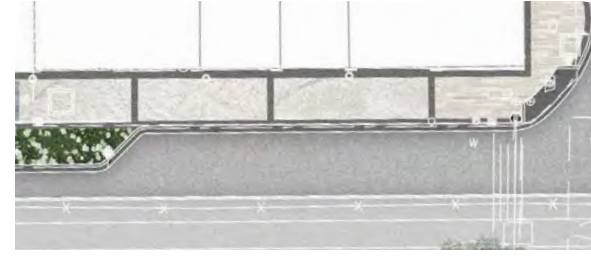

Crossings: Juperana *Herringbone Pattern*

Footpath Paving: Juperana *Stretcherbond Pattern*

Moseley Piazza: Juperana *Pattern TBC*



Cobbleset Banding:
Austral Black Stone

Footpaths: 100 mm x 100 mm x 40 mm [charcoal oxide mortar]

Crossovers: 100 mm x 100 mm x 60 mm

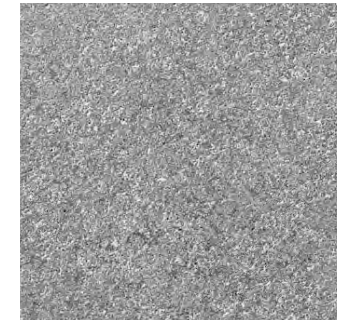

On-street Carpark Pavement
Asphalt



Semi-mountable Kerb
Black oxide to match existing Chapel St Plaza works



Upright Kerb
Black oxide to match existing Chapel St Plaza works



Footpath, Feature + Crossover Paving:
Juperana Granite

Footpaths: 400 mm x 200 mm x 40 mm in Stretcherbond

Feature Paving: Juperana Granite - various sizes, random pattern to match City Zone

Crossovers: Juperana Granite - 400 mm x 200 mm x 60 mm in Herringbone



Corten Edging
to garden beds where required



Bin Enclosure
to match Chapel St Plaza



Bike Racks
Street Furniture Australia to match Chapel St Plaza



Bollards
Street Furniture Australia to match Chapel St Plaza



Strip Lights (Trafficable)
to be developed during detailed design



Seat on Plinth
Seats along Colley Terrace to match Chapel St Plaza

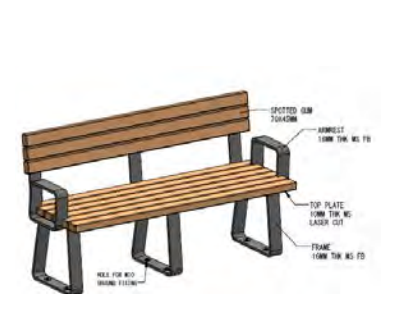

Seat
Seats along Jetty Road to match Chapel St Plaza with extended legs in place of plinth

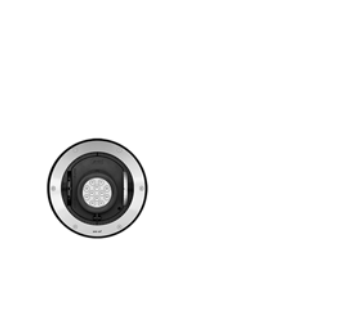

Tree Uplights
to be developed during detailed design

Contact Tract

Adelaide
Kaurna Country
265 Pirie St, Adelaide SA, Australia 5000
(08) 8223 1324
adelaide@tract.net.au



Option Blue - Colley Terrace looking south



Option Green - Colley Terrace looking south



Option Yellow - Colley Terrace looking south



Durham Street mini plaza, Jetty Road looking west



Signalisation of Moseley Street, Jetty Road looking east



Corner St Johns Row, Moseley Square looking east



Jetty Road looking into Moseley Square



Activated Transition zone, Jetty Road looking west



Southern side of Moseley Square, options green and blue



Southern side of Moseley Square, yellow option

Attachment 3

TRANSFORMING JETTY ROAD GLENELG

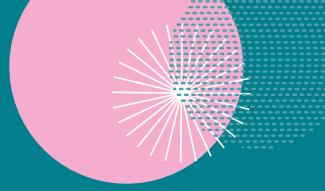

We invite your feedback on
the Coast and Transition zone
concepts



Concept image: Jetty Road/Colley Terrace corner looking west to Moseley Square

A once-in-a-generation transformation

The Transforming Jetty Road Glenelg project will cement Glenelg as Adelaide's premier coastal shopping, dining and entertainment destination, while remaining the heart of our local community.

It aims to transform the precinct into a modern, safe, vibrant and accessible destination for all who live here and come to visit.

This once-in-a-generation development will preserve Jetty Road's unique culture and history, while at the same time futureproofing it for generations to come.

We invite you to share your feedback on a range of draft concept designs for the Transforming Jetty Road project, specifically for the Transition and Coast zones which is from the Patridge/Gordon Street intersection to the fringe of Moseley Square and into Colley Terrace.

VISION FOR JETTY ROAD, GLENELG

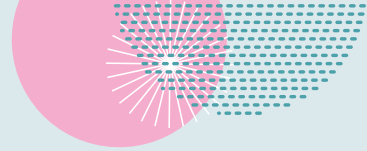

Transforming Jetty Road, Glenelg

Jetty Road, Glenelg is unlike other high streets, at almost a kilometre long and with over 300 businesses, its use can vary depending on where you are on the street, the time of year, and even from weekdays to weekends.

Based on this, the street has been categorised into three distinct zones - City, Transition and Coast.

The **City zone** is the Brighton Road end of Jetty Road and is mostly used by local residents and shoppers.

The **Coast zone**, at the Moseley Square corner, attracts high volume of pedestrians and predominantly visitors to the Bay.

The **Transition zone** is where people transition from one zone to another and is dominated by outdoor dining and is used by both locals and visitors.

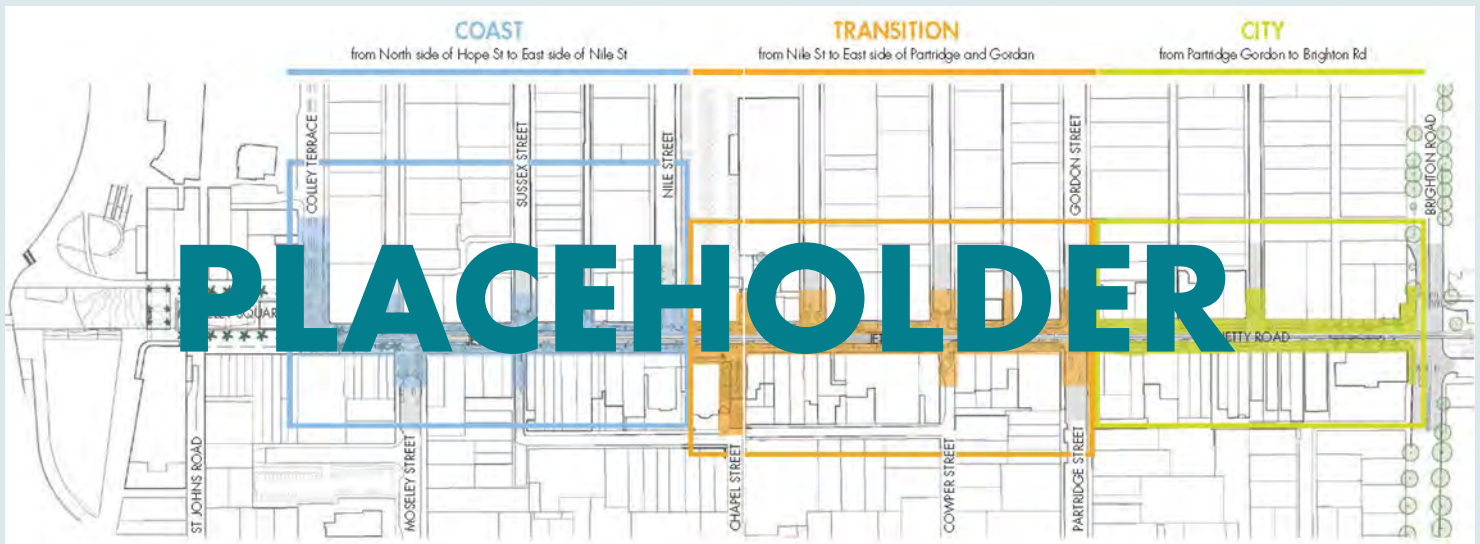

A call for transformation

Jetty Road has a tendency for over-crowding particularly in the summer months, causing functional and safety concerns for the pedestrians, businesses and vehicles that share the street.

Historically, vehicle movement has been prioritised, in conflict with the volume of pedestrians who visit the street.

We have heard the community's concerns about pedestrian safety within the Coast zone, in particular where Moseley Street intersects with Jetty Road. Pedestrians and drivers also find the crossing on Colley Terrace confusing, with both users unclear who should give way safely.

Within the Coast zone of Jetty Road are two major intersections: Colley Tce/Jetty Road and Moseley St/Jetty Road, the junction of which sees approximately xx pedestrians, with xx private vehicles, xx bus movements and xx tram movements travelling across these two crossings.

For years, community and businesses have expressed their concern about the street looking tired, outdated and out of touch with other major coastal destinations and high streets.

The vision is to transform the Jetty Road precinct into a modern, safe, vibrant and accessible destination for all who live here and come to visit.

Turning vision into concepts

We have investigated all options to make this vision happen and now presents a range of concepts that meet federal and

Council funding and operational requirements, while realising the vision for Transforming Jetty Road.

We have formulated a range of concepts that address the concerns and balance the prioritisation between vehicles and pedestrians.

We're pleased to present three design concepts for the Coast zone – yellow, green and blue - along with a concept for the Transition zone.

All concepts include:

- The installation of signalised crossing at the Moseley Street/Jetty Road intersection with a scramble crossing for pedestrians to move safely through the intersection
- The same concept design for the Transition zone which includes roll-on/roll-off parking spaces, Juperana pavers along the footpaths, additional greenery and feature lighting
- Retention of the Glenelg tram route along Jetty Road and into Moseley Square
- Reduction of speed limit along Jetty Road from 40km/h to 30km/h
- Reconfiguration of the area along the southern side of the tram line in Moseley Square

The three concept designs for the Coast zone fulfill the same goal in a spectrum of ways: to improve pedestrian safety, accessibility and the overall experience when visiting Jetty Road.

We invite you to learn more about each of the proposed concepts and share your feedback to help shape the next steps in Transforming Jetty Road.



SIGNALISED CROSSING

Moseley Street / Jetty Road intersection concepts

Traffic lights installed to regulate and guide traffic to give pedestrians priority over vehicles. This will give pedestrians clear, protected times to cross thereby reducing the risk of collisions and improving traffic flow in this pedestrian-heavy intersection.



Concept image: Durham Street closure, looking west down Jetty Road

The Moseley Street intersection with Jetty Road is approximately 20 metres wide and carries xxx traffic movements each day, including buses and private vehicles.

All vehicles have the ability to turn left or right into Jetty Road, with traffic also turning into Moseley Street from Jetty Road, in both directions. There are also xxx tram movements daily along Jetty Road, to and from Moseley Square.

This intersection is also one of the busiest pedestrian crossing points in Glenelg, but it is not clear to pedestrians or motorists who has right of way.

The key outcome for this intersection is the installation of traffic signals to regulate and guide traffic, including cars, buses and pedestrians, through the intersection.

It is also proposed that this signalised intersection will be a pedestrian scramble crossing, which temporarily stops all vehicular traffic and allows pedestrians to cross the intersection in every direction, including diagonally, at the same time.

This would allow pedestrians to cross Moseley Street and Jetty Road at the same time. This would be more efficient for pedestrians but more impactful for vehicles using the intersection.

Estimated traffic delays through the signalised intersection for each of the three concepts which are detailed on the following pages.

	Concept Yellow	Concept Green	Concept Blue
Weekday peak times delay	between 1.5 to 3 minutes	20 to 25 seconds	15 to 20 seconds
Weekend peak times delay	up to 10 minutes	1 minute	30 seconds

Weekday morning peak times: 8am - 9am
Weekday afternoon peak times: 4pm - 5pm
Weekend peak times: 12pm - 1pm



Concept image: Moseley Street intersection, looking east up Jetty Road



COAST ZONE - CONCEPT YELLOW

Colley Terrace corner open to traffic concept

Concept Yellow maintains all vehicle access along Jetty Rd and Colley Tce. Pedestrian safety improved with the installation of traffic lights at the intersection of Moseley St and Jetty Rd.

Road and footpaths to be at the same level along with increased greenery, integrated outdoor dining, new street furniture and feature lighting.



Concept image: Colley Terrace from the Glenelg Library looking south

Pedestrians

Pedestrians will be aided by new traffic lights at the Moseley St/Jetty Rd intersection through Jetty Rd and Colley Tce.

Vehicles

Private vehicle, bus and tram movement retained

Road operations

- Moseley St intersection signalised for safer pedestrian crossing
- Reduction of speed limit from 40km/h to 30km/h on Jetty Rd and Colley Tce
- Changes to Durham St:
 - **Variation 1: Closure of Durham St entry** from Jetty Rd to create a small plaza
Durham St converted to two-way movements, with the Durham St carriageway at the junction of Augusta St widened to enable two-way traffic. Addition of a turning circle on Durham St. Reduction of 6 parking spaces
 - **Variation 2: Access to Durham Rd via a left-hand turn from Jetty Rd.** Durham Street remains one-way, travelling north. Reduction of 3 parking spaces

Parking

- 20 on-street parking spaces removed in the Coast zone to facilitate the signalised crossing at Moseley/Jetty, Durham

St closure, widened footpaths, additional greenery and improved accessibility

- Total loss of 26 parking spaces within the Jetty Rd precinct (20 Coast zone, 4 Transition zone, 2 City zone)
- To view details and maps of the proposed parking space losses visit transformingjettyroad.com

Design

- Installation of Juperana pavers along Jetty Rd
- Palm trees on west side of Colley Tce
- The road and footpath to be at the same level on Colley Tce from Hope St through to the junction of Jetty Rd and Sussex St
- Continuous footpaths on Jetty Rd junctions with side streets where possible
- Continuous footpaths along Jetty Rd junctions with side streets where possible, in which the roadway intersection is raised to the same level as the footpath. Vehicles are required to give way to pedestrians on continuous footpaths.
- Additional greenery and street furniture
- Feature lighting including uplighting on all trees and the inclusion of feature strip lighting in the footpaths around the fringes of Moseley Sq and at the Durham St mini plaza.

For more information and to view detailed plans for each concept as featured in this brochure visit transformingjettyroad.com or scan the QR code.



Turn to the back page of this brochure to see all the ways you can get more information and to share your feedback.



COAST ZONE - CONCEPT GREEN

Colley Terrace corner closed to traffic (except public transport) concept

Concept Green enhances the pedestrian experience with new traffic lights at the Moseley St/Jetty Rd intersection. The corner of Jetty Rd and Colley Tce closed to all traffic except trams and buses, which will continue to operate unchanged.

Road and footpaths to be at the same level along with increased greenery, new street furniture and feature lighting. With the reduction of traffic at the Colley Tce corner, pedestrians are given priority and increased space for outdoor dining and the creation of a plaza feel to integrate with Moseley Sq.



Pedestrians

- Flush 'shared zone' in Colley Tce (from Hope St) to Jetty Rd (Moseley St) gives pedestrians priority, and creates a plaza feel to integrate with Moseley Sq
- Pedestrians will be aided by new traffic lights at the Moseley St/Jetty Rd intersection

Private vehicles

- Closure of Colley Tce (Hope St) to Jetty Rd (Moseley St) to all private vehicles
- Signalised intersection of Moseley St/Jetty Rd

Buses

- Buses remain unchanged (two-way bus movements retained through Colley Tce)

Trams

- No changes to tram operations

Road operations

- Moseley St intersection signalised for safer pedestrian crossing
- Slightly narrowed carriageway on Colley Tce to create additional space for pedestrians, outdoor dining, activation opportunities and trees/greenery
- Closure of Durham St entry from Jetty Rd to create a small plaza. Durham St converted to two-way movements, with the Durham St carriageway at the junction of Augusta St widened to enable two-way traffic. Addition of a turning circle on Durham St
- New right hand turn from Augusta St into Colley Tce

- Reduction of speed limit from 40km/h to 30km/h on Jetty Rd and Colley Tce
- Speed limit reduced to 10km/h from Jetty Rd at Moseley St through Colley Tce junction with Hope St
- Additional of a turning circle on Colley Tce north of the junction with Hope St
- Removal of right hand turn from Colley Tce (southbound) into Wilson car park that services the Beachouse and Platinum Apartments

Parking

- 33 on-street parking spaces removed in the Coast zone to facilitate the closure of the Jetty Rd/Colley Tce corner to traffic (except public transport), the signalised crossing at Moseley/Jetty, Durham St closure, widened footpaths, additional greening and improved accessibility
- Total loss of 39 parking spaces within the Jetty Rd precinct (33 Coast zone, 4 Transition zone, 2 City zone)
- To view details and maps of the proposed parking space losses visit transformingjettyroad.com

Design

- Installation of Juperana pavers along Jetty Rd
- Palm trees on both sides of Colley Tce
- The road and footpath to be at the same level on Colley Tce from Hope St through to the junction of Jetty Rd and Sussex St
- Continuous footpaths on Jetty Rd junctions with side streets where possible
- Additional greenery, street furniture and feature lighting



COAST ZONE - CONCEPT BLUE

Colley Tce corner closed to traffic (except public transport) and with bus route changes concept

Concept Blue fully transforms the Coast zone into a pedestrian-focused zone shared with trams and buses and aided by new traffic lights at the Moseley St/Jetty Rd intersection. The corner of Jetty Rd and Colley Tce will be closed to all traffic except trams and buses, but with changes to existing bus routes to further reduce vehicle movement through Colley Tce.

Road and footpaths at the same level along with increased greenery, new street furniture and feature lighting. With the further reduction of traffic at the Colley Tce corner, pedestrians have priority and increased space for outdoor dining and the creation of a plaza feel to integrate with Moseley Sq.



Pedestrians

- Flush 'shared zone' in Colley Tce (from Hope St) to Jetty Rd (Moseley St) gives pedestrians priority, and creates a plaza feel to integrate with Moseley Sq
- Pedestrians will be aided by new traffic lights at the Moseley St/Jetty Rd intersection
- Reduced bus movements through the Colley/Jetty corner to enhance pedestrian amenity and safety

Private vehicles

- Closure of Colley Tce (Hope St) to Jetty Rd (Moseley St) to all private vehicles
- Signalised intersection of Moseley St/Jetty Rd

Buses

- Changed bus routes and new bus stops
- One-way westbound bus movements from Moseley St through to Colley Tce. Resulting in a reduction of 192 daily bus movements through the Jetty Rd/Colley Tce corner, and therefore additional bus movements along Jetty Rd
- New bus stops on Jetty Rd, Gordon St and Moseley St
- New bus layovers at Moseley St

Trams

- No changes to tram operations

Road operations

- Moseley St intersection signalised for safer pedestrian crossing
- Narrowed carriageway on Colley Tce to maximise space for pedestrians, outdoor dining, activation opportunities and trees/greenery
- Closure of Durham St entry from Jetty Rd to create a small

plaza. Durham St converted to two way movements, with the Durham St carriageway at the junction of Augusta St widened to enable two way traffic. Addition of a turning circle on Durham St

- New right hand turn from Augusta St into Colley Tce
- Reduction of speed limit from 40km/h to 30km/h on Jetty Rd and Colley Tce
- Speed limit reduced to 10km/h from Jetty Rd at Moseley St through Colley Tce junction with Hope St
- Addition of a turning circle on Colley Tce north of the junction with Hope St
- Removal of right hand turn from Colley Tce (southbound) into Wilson car park that services the Beachouse and Platinum Apartments

Parking

- 50 on-street parking spaces removed in the Coast zone
- Total loss of 56 parking spaces within the Jetty Rd precinct (50 Coast zone, 4 Transition zone, 2 City zone)
- To view details and maps of the proposed parking space losses visit transformingjettyroad.com

Design

- Installation of Juperana pavers along Jetty Rd
- Palm trees on both sides of Colley Tce
- The road and footpath to be at the same level on Colley Tce from Hope St to the junction of Jetty Rd and Sussex St
- Continuous footpaths on Jetty Rd junctions with side streets where possible
- Additional greenery, street furniture and feature lighting
- Kerb line on northwestern corner of Gordon St with Jetty Rd widened



TRANSITION ZONE CONCEPT

The Transition zone starts at the Partridge St/Gordon St intersection on Jetty Rd and extends west to Nile St. This zone is predominantly retail and commercial in nature. Within the Transition zone are Chapel Plaza and Bouchee Walk, which were upgraded in 2021 as the first stage of the Transforming Jetty Road project.

One concept design is proposed for the Transition zone. A key design element is the introduction of roll-on/roll-off kerbs which will turn parking bays into flexible spaces which can be used for parking or transformed into outdoor dining, retail, event and activation spaces.



Concept image: Looking west along the southern footpath of Jetty Road

Pedestrians

- Increased footpath space when flexible parking spaces are utilised

Traffic operations

- Vehicle, tram and bus movements retained
- Reduction of speed limit from 40km/h to 30km/h on Jetty Rd and Colley Tce

Parking

- Roll-on/roll-off kerbs to enable parking bays to be used as flexible spaces

- 4 on-street parking spaces removed in the Transition zone
- To view details and maps of the proposed parking space losses visit transformingjettyroad.com

Design

- Installation of Juperana pavers along Jetty Rd
- Additional trees and retainment of all healthy existing trees for increased green canopy cover and associated street shading
- Continuous footpaths on Jetty Rd junctions with side streets where possible
- Additional greenery, street furniture and feature lighting



MOSELEY SQUARE CONCEPT

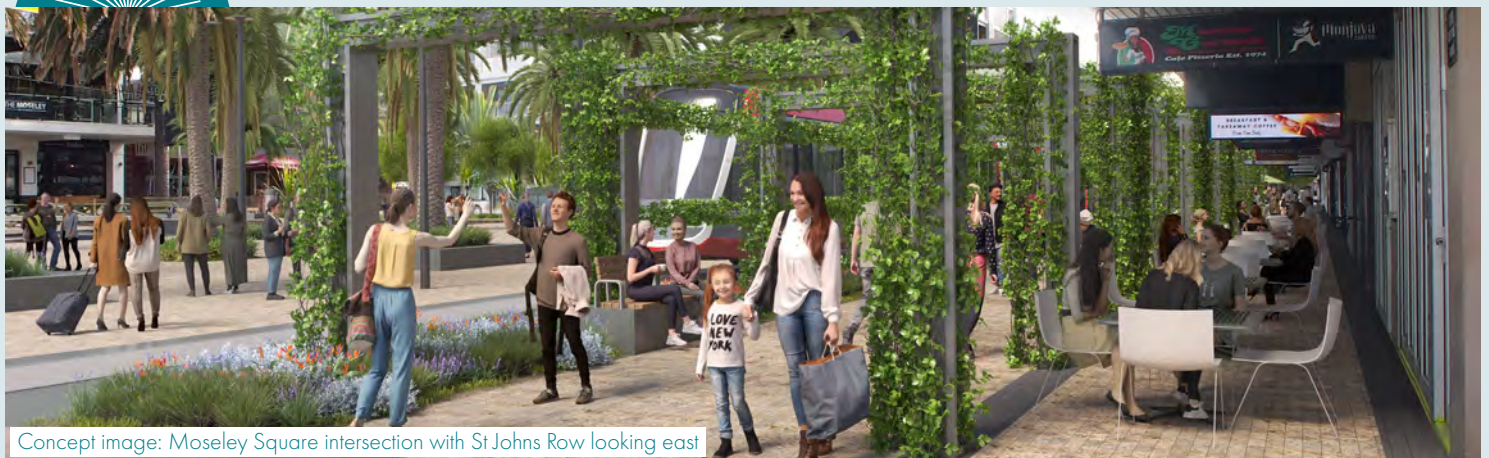

Concept image: Moseley Square intersection with St Johns Row looking east

Moseley Square will continue to be serviced by the Glenelg tram, which has been part of the fabric of Jetty Road for almost a century.

Council is continuing to work with the Department of Infrastructure and Transport to investigate improvements of how the infrastructure at the tram stop interacts with the planned upgrades of Jetty Road.

It is proposed that the maze pedestrian crossing will be removed and the concrete planter boxes, that run along the

southern side of the tram line, will be replaced with low level planting.

Outdoor dining provisions for traders on the southern side of Moseley Square will be moved closer to the building lines.

This means the current outdoor dining area will become a pedestrian thoroughfare with a green arbor constructed to increase shade and complement the planting along the tram line.

Share your feedback on the draft concept designs proposed for the Transition and Coast zones.

You can view the concept plans and share your feedback in the following ways:



Online

View the draft concept designs and submit your feedback at transformingjettyroad.com



Email

mail@holdfast.sa.gov.au with the subject header: Transforming Jetty Road



In writing

Transforming Jetty Road Glenelg
PO Box 19
Brighton SA 5048



In person

Glenelg Library, 2 Colley Terrace, Glenelg
Brighton Library, 20 Jetty Road, Brighton
Brighton Civic Centre, 24 Jetty Road, Brighton



By phone

8229 9999 during office hours



Community Drop-in sessions

Drop by between any of the following times to learn more and have a 1:1 chat with a project team member.

Tuesday 27 February, 11 am - 1 pm

Holdfast Bay Community Centre
51 King George Avenue, Hove

Wednesday 5 March, 4pm - 6pm

Popup xxx
XX Glenelg

Thursday 6 March, 4pm - 6pm

Popup xxx
XX Glenelg

Wednesday 12 March, 4pm - 6pm

Kauri Community and Sport Centre
Kauri Parade & Scholefield Road, Seacliff

Saturday 15 March, 10am - 2pm

Popup xxx
XX Glenelg

Wednesday 19 March, 4pm - 6pm

Glenelg North Community Centre
Kibby Reserve, Alison Street, Glenelg North

For your feedback to be considered, it must be received by **5pm, Wednesday 26 March 2025.**

transformingjettyroad.com

8229 9999

transformingjettyroad@holdfast.sa.gov.au

Find out more here



Attachment 4

Attachment 4 Stakeholder Communication and Consultation Overview

Stakeholder group	Communication	Consultation
<p>City-wide residents (and wider community)</p>	<p>Direct communication</p> <ul style="list-style-type: none"> Project brochure mailout to 19,000 Holdfast Bay households Project website – transformingjettyroad.com Social media campaign Holdfast News e-newsletter YourHoldfast database email Public notice advertisement – The Advertiser Media release / news on holdfast.sa.gov.au Jetty Road Glenelg consumer e-news Mayor doorknocking initiative <p>Promotions</p> <ul style="list-style-type: none"> Community digital LED screens Tram / bus shelters Bin corflutes Moseley Square banner Corflutes at community parks and reserves Displays in council libraries and Brighton Civic Centre Displays on public computers within Brighton and Glenelg libraries 	<p>Feedback</p> <ul style="list-style-type: none"> Online feedback via website Hardcopy survey via libraries, civic centre, drop-in sessions and by request Mail Phone Email Request to meet with project team <p>In-person</p> <ul style="list-style-type: none"> Community drop-in sessions held at a pop-up store on Jetty Road Glenelg, and in locations across Holdfast Bay
<p>Immediate residents</p>	<p><i>In addition to all methods listed above (City-wide residents):</i></p> <ul style="list-style-type: none"> Localised letter mail-out to people directly affected by road closure options 	<p><i>In addition to all methods listed above (City-wide residents):</i></p> <ul style="list-style-type: none"> Localised drop-in sessions for specific resident groups (Durham Street, Platinum Apartments, and Colley Terrace)
<p>Landlords</p>	<p>Direct communication <i>In addition to all methods listed above (City-wide residents):</i></p> <ul style="list-style-type: none"> Landlord lunch pre-inform session Individual letter and email 	
<p>Businesses</p>	<p><i>In addition to all methods listed above (City-wide residents):</i></p> <ul style="list-style-type: none"> Jetty Road businesses e-newsletter Jetty Road businesses Facebook group Council staff drop in – staff to visit each business Postcard 	<p><i>In addition to all methods listed above (City-wide residents):</i></p> <ul style="list-style-type: none"> Dedicated drop-in session for traders held at a pop-up store on Jetty Road Glenelg
<p>Special interest and community groups</p> <ul style="list-style-type: none"> Schools within Holdfast Bay St Andrews by the Sea St Peter’s Church Glenelg Surf Lifesaving Club Holdfast Shores Marina / JLL SATC TICSA Western Adelaide Alliance Councils Adelaide Airport Authority HBRA and 5049 Coastal Community HoldUp Youth Disability Inclusion Reference Group 	<p><i>In addition to all methods listed above (City-wide residents):</i></p> <ul style="list-style-type: none"> Email/letter along with project brochure Provision of e-newsletter/email content to distribute through their own channels 	
<p>Government</p> <ul style="list-style-type: none"> Louise Miller-Frost MP Member for Boothby Stephen Patterson MP Member for Morphett Sarah Andrews MP Member for Gibson Alex Dighton MP Member for Black Peter Malinauskas MP Premier of South Australia Zoe Bettison MP Minister for Tourism Tom Koutsantonis MP Minister for Infrastructure and Transport Joe Szakacs MP Minister for Local Government <p>DIT</p>	<p><i>In addition to all methods listed above (City-wide residents):</i></p> <ul style="list-style-type: none"> Email/letter along with project brochure 	